

VIEW AT TOP
NO SHEATHING REQ'D.

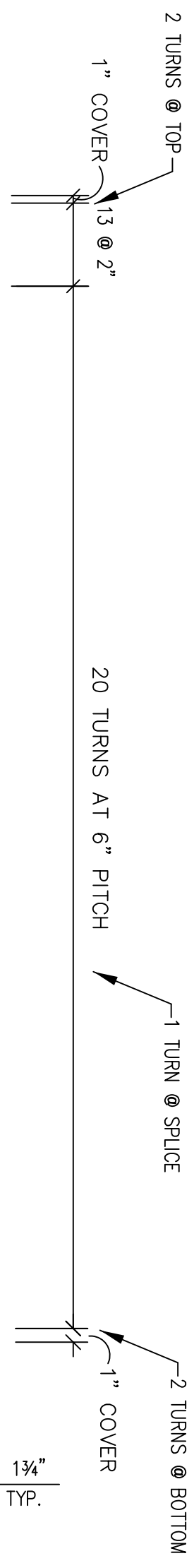

STRESSED STRAND
NOT SHOWN FOR CLARITY

REINFORCING
N.T.S.

5 GA. SPIRALS (TYP.)

12'-0"

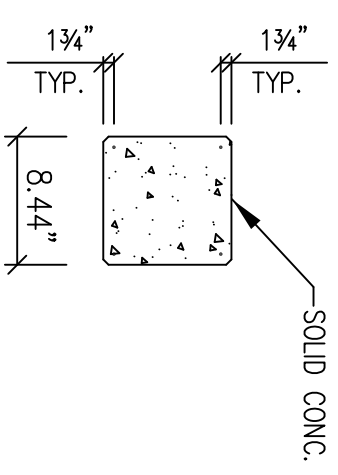

VIEW AT BUTT

(4) 3/8" @ 270K 'LOW-LAX'
STRAND AT 14,000# EACH

#5 GAUGE SPIRAL



SOLID

SECT. AT 6'-0" FROM BUTT

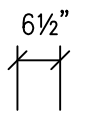

POLE ELEVATION
N.T.S.

NOTE: ALL EMBEDS ARE ± 3" U.O.N.
I.D. DETAILS = MANUFACTURER, CUSTOMER, WT,
DATE MFG, POLE TYPE, LENGTH
& FINANCIAL PROJECT ID

NOTE: POLE MUST BE PICKED UP AND STORED
AT TWO POINTS, APPROX. 2 FT. FROM TOP AND
2 FT. FROM BUTT. CAUTION: LIFTING THIS POLE
WITH A SINGLE POINT PICK-UP WILL RESULT IN
DAMAGE TO THE POLE.

NOTE: THIS POLE SHALL MEET OR EXCEED
REQUIREMENTS SET FORTH BY F.D.O.T. SPECIFICATIONS.

QTY: 2-PII-12'

MATERIALS SPECIFICATION	
A) F'c = 6,000 PSI (28 DAYS)	
B) F'ci = 4,000 PSI (RELEASE)	
C) FS = 270 KSI FOR PRESTRESSING STRANDS COMPLYING WITH ASTM A416	
D) FY = 60 KSI FOR STIRRUPS AND REINFORCING BARS PER ASTM A615	
E) FY = 60 KSI SPIRAL WIRE	ASTM A1064

TYPE P-11A (SERVICE POLE)



DURA-STRESS Inc.
P.O. BOX 490779 LEESBURG, FL 34749-0779
PHONE (352) 787-1422 FAX. (352) 787-0080
STRUCTURAL PRESTRESSED AND ARCHITECTURAL PRECAST CONCRETE PRODUCTS

REV	DESCRIPTION	DATE	BY	CHK.

JOB NAME:
LOCATION:
ARCHITECT:
ENGINEER:
CONTRACTOR:
PROJ. NO:

DRAWN:
CHK'D.:
APPR.:
DATE: :
RELEASED:

DS JOB NO:
SHT: OF: